

296'-6"

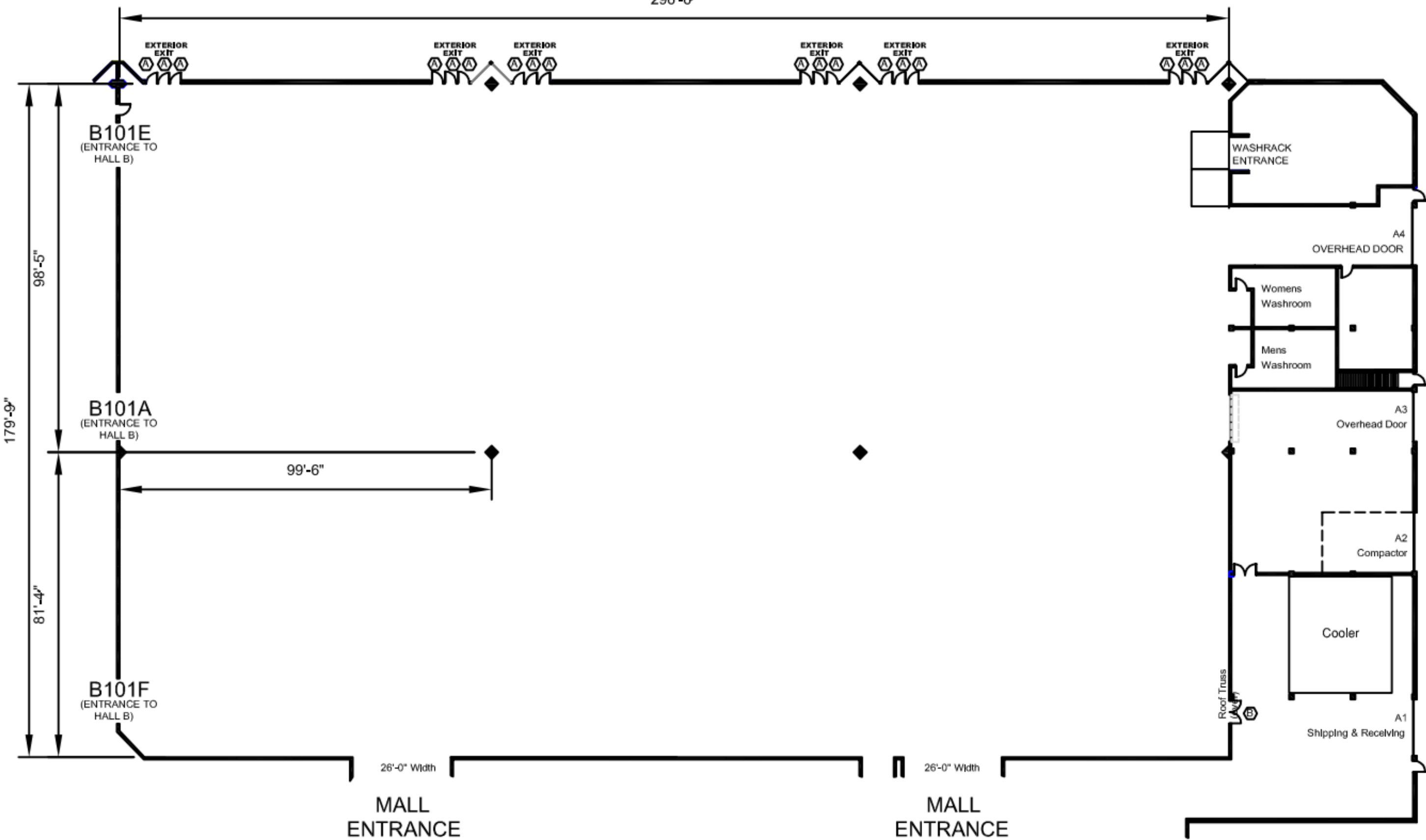

179'-9"

98'-5"

81'-4"

99'-6"

26'-0" Width

26'-0" Width

MALL ENTRANCE

MALL ENTRANCE

B101E
(ENTRANCE TO HALL B)

B101A
(ENTRANCE TO HALL B)

B101F
(ENTRANCE TO HALL B)

EXTERIOR EXIT
A A A

EXTERIOR EXIT
A A A

EXTERIOR EXIT
A A A

EXTERIOR EXIT
A A A

EXTERIOR EXIT
A A A

EXTERIOR EXIT
A A A

WASHRACK ENTRANCE

A4
OVERHEAD DOOR

Womens Washroom

Mens Washroom

A3
Overhead Door

A2
Compactor

Cooler

A1
Shipping & Receiving

Roof Truss